



Tap Into The Global Well

**AERstream GW Pro
Atmospheric Water Generator**

User Manual

IMPORTANT SAFETY INSTRUCTIONS



WARNING

Electrical Information

- For your safety and protection, this atmospheric water generation machine is equipped with a standard plug on the power cord that meets local electrical code. Do not, under any circumstances, cut or remove the round ground prong from the plug.
- Your atmospheric water generator machine must be plugged directly into a properly grounded and polarized receptacle. If you are not sure the outlet is adequately grounded or protected by a time delay fuse or circuit breaker, have a qualified electrician install the proper outlet according to the National Electrical Code and applicable local codes and ordinances.
- Never unplug the machine by pulling on the power cord. Always grip the plug firmly and pull straight out from the receptacle.
- Do not pinch, bend, or knot the power cord.

Child Safety Precautions

- Destroy the carton, plastic bags, and any packing materials immediately after the machine is unpacked. Children should never use these items for play.
- Do not leave children unattended in an area where the machine is operating. Do not allow them to sit or stand on the appliance.
- This machine is not intended for use by persons (including children) with reduced physical, sensory or mental capabilities or lack of experience and knowledge, unless they have been given supervision or instruction concerning use of the machine by a person responsible for their safety.
- Children should be supervised when operating the machine.



SAFETY PRECAUTIONS

CAUTION! Avoid Injury or damage to the unit or other property

- Do not direct airflow at fireplaces or other heat related sources.
- Do not climb on or place objects on the unit.
- Do not hang objects off the unit.
- Do not place containers with liquids on the unit.
- Turn off the machine at the power source when it will not be used for an extended period.
- Operate the unit with air filter in place.
- Do not block or cover the intake grille, discharge area and outlet ports.
- Ensure that any electrical/electronic equipment is one yard away from the unit.
- Disconnect the power before maintenance.
- Always keep the machine in the upright position.
- Water tanks must be drained before the machine is moved to avoid internal water spillage.

DANGER! Avoid Serious Injury or Death

- This machine contains no user-serviceable parts. Always call an authorized servicer for repairs.
- Do not insert or place fingers or objects into the air discharge area or side grille of the unit.
- Do not start or stop the machine by unplugging the power cord or turning off the power at the electrical box while it is running.
- Do not cut or damage the power cord. Do not pull on the power cord.
- The machine shall be installed in accordance with national wiring regulations.
- In the event of a malfunction (abnormal noise, smell, temperature, leakage etc.), immediately stop the operation, disconnect the power cord, and call an authorized servicer.

What is in the box

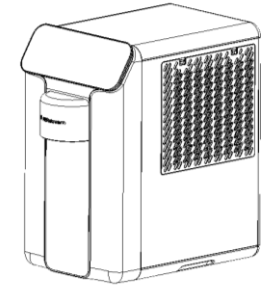

AERstream
Atmospheric Water Generation Machine x 1

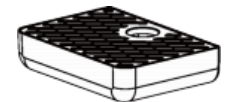

Water Pan x 1



Power Cord x 1



Air Filter x 1
(Pre-Installed)



Water Filtration Cartridge Set (3PCS) x 1
(Pre-Installed)

SETUP GUIDE

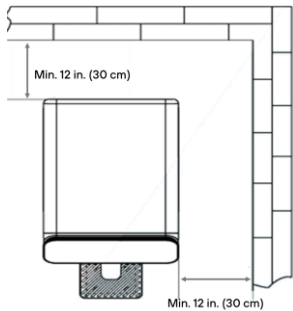

! IMPORTANT !

- Place the machine on a leveled surface.
- Leave min.12 in. (30cm) clearance for the air inlet (the right side of the display panel) and the air outlet (back)
- Keep the machine at the set location for 4 hours before plug in.

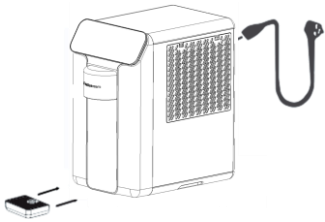

- Place the water pan and plug in the machine.



- Tap the POWER button to turn on the machine.



- Tap the DISPENSE button to dispense water. Tap again to stop water dispensing.

NOTE

- Water can only be dispensed when WATER LEVEL indicator becomes solid.
- Water dispensing will automatically stop when WATER LEVEL indicator starts flashing.
- When using the machine at the first time or after the water filtration cartridges are being replaced, dispense couple of gallons water to clear out any impurities or air.

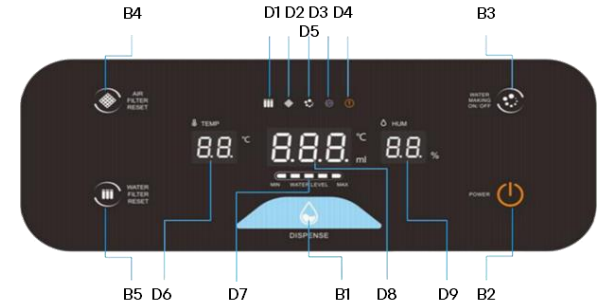



Control and Display Panel		
	BUTTONS	STATUS
B1	<u>Water dispensing button</u> Single tap to Dispense / Stop water	-
B2	<u>Power button</u> Single tap to turn ON/OFF the machine	-
B3	<u>Water production button</u> Single tap to start/stop water production	<u>Flashing</u> Water is in production
		<u>Solid On</u> The machine is ready to produce water
		<u>Off</u> Water production stops. (Fan will be automatically switched off when water production stops)
B4	<u>Air filter rest button</u> Tap and hold for 2 seconds to reset after air filter is replaced.	<u>Flashing</u> Time to change the air filter.
B5	<u>Water filter rest button</u> Tap and hold for 2 seconds to reset after water filter cartridges are replaced.	<u>Flashing</u> Time to change the water filter cartridges.

Control and Display Panel (Continued)		
DISPLAYS		STATUS
D1	Water filter replacement reminder	<u>Solid On</u> Water filter replacement is needed.
D2	Air filter replacement reminder	<u>Solid On</u> Air filter replacement is needed.
D3	UV Sterilization	<u>Solid On</u> UV sterilization is in progress.
D4	System warning	<u>Flashing</u> The machine is not functioning correctly. Error codes will be displayed. See the Error Codes table for details.
D5	Water production indicator	<u>Solid On</u> The machine is producing water. <u>Flashing</u> The machine is in refrigeration mode to chill the water.
D6	Ambient temperature reading	<u>Flashing</u> The reading will be flashing when ambient temperature below 5°C (41°F)
D7	Water production level indicator	<u>Flashing</u> Water level is low. Water dispensing will be automatically disabled until water level comes back up
D8	Drinking water temperature	Dispensed water temperature.
D9	Ambient humidity reading	<u>Flashing</u> : The reading will be flashing when ambient humidity below 35% and water production will be stopped.

MAINTAINACE

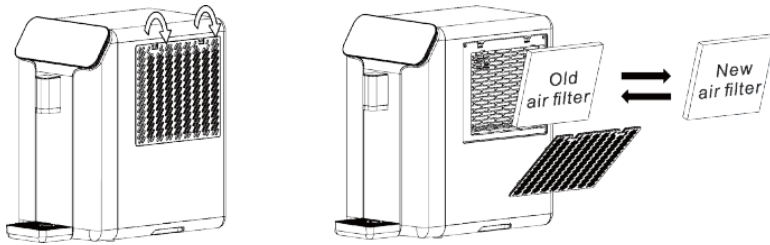
Air Filter Replacement



1. Press the tabs on the cover of the air filter bay located at the right side of the control panel.
2. Replace the old filter with a new one.
3.  AIR FILTER RESET Tap and hold for 2 second to reset.

Water Filter Cartridge Replacement

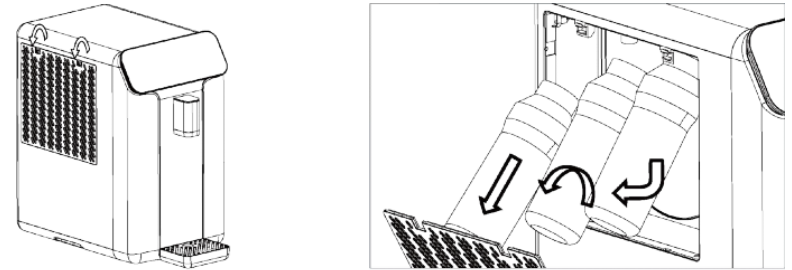

1. Press the tabs on the cove of the water filter bay located on the left side of the control panel.
2. Twist each water filter cartridge clockwise to remove it.
3. Install each new water filter cartridge by twisting it counterclockwise until it locks in place.
4.  WATER FILTER RESET Tap and hold for 2 second to reset.

! IMPORTANT !

- All 3 water filter cartridges must be replaced at the same time.
- Use the matching marks on both the cartridge and the machine to ensure correct installation.

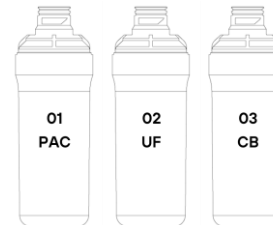

Matching mark on the machine

MAINTAINACE

Cleaning Water Collection Tank

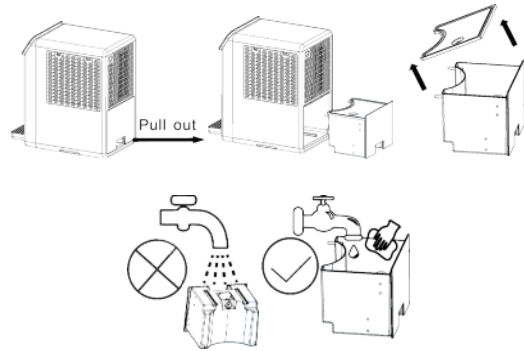

1. Ensure the machine is turned off and unplugged from the power source.
2. Pull out the water collection tank from the back of the machine.
3. Remove the top cover of the tank
4. Gently rinse only the inner surface of the tank with water.
5. Wipe and dry the tank with clean towel.
6. Put the top cover back on.
7. Push the tank back into place.

! IMPORTANT !

- Avoid using any corrosive cleaning solutions, such as alcohol or acetone.
- Keep water away from the UV module electronics located at the bottom outside of the tank.
- If the water collection tank is not properly installed after cleaning, an "E8" error code will be displayed. To clear the error, turn off the power, reinstall the tank, and then restore power.

TROUBLE SHOOTING – COMMON ISSUE

Common Issue	Possible Cause	Solution
Water production is very slow,. Or discontinued	<ol style="list-style-type: none"> 1. Ambient temperature and/or humidity is outside the working range. 2. Air inlet and/or air outlet is blocked. 3. Power interruption or unstable power source. 4. The compressor is over heating 	<ol style="list-style-type: none"> 1. The machine will only produce water when the ambient temperature is between 5°C (41°F) - 32°C (89°F) and humidity level is above 35%. 2. Ensure there is sufficient clearance around the machine's air inlet and air outlet. 3. Ensure the machine is plugged into a stable, uninterrupted power source. 4. If the compressor's operating temperature exceeds the limit, the thermal protection feature will activate, causing the compressor to restart after 3 minutes. If the issue persists, please contact customer service for support.
Water is not dispensing	<ol style="list-style-type: none"> 1. Water level is low. 2. Power interruption. 	<ol style="list-style-type: none"> 1. Wait until WATER LEVEL indicator becomes solid. 2. Wait for 1 minute after the power is reconnected.

Common Issue	Possible Cause	Solution
Water Leakage	<ol style="list-style-type: none"> 1. The machine is being tilted when it is moved causing the water spilled out from the water tanks. 2. The machine is not leveled correctly. 	<ol style="list-style-type: none"> 1. Maintain the machine upright position while moving it. 2. Make sure the machine is leveled correctly before the use.

TROUBLE SHOOTING – ERROR CODE

Error Code	Error Message	Error Description
E A	Ambient temperature and humidity sensor error	Faulty sensor, open circuit / short circuit
E 1	Condenser temperature sensor error 1	Abnormal sensor resistance value, condenser overcooling / overheating.
E 2	Condenser temperature sensor error 2	Faulty sensor, open circuit
E 3	Condenser temperature sensor error 3	Faulty sensor, short circuit
E 4	Water cooling temperature sensor error 1	Abnormal sensor resistance value, overcooling / overheating
E 5	Water cooling temperature sensor error 2	Faulty sensor, open circuit
E 6	Water cooling temperature sensor error 3	Faulty sensor, short circuit
E 7	Defrosting error	Defrosting mode is activated for 2 consecutive times when the ambient temperature is above 5°C (41°F) and humidity is above 35%.
E 8	Water level sensor error, water collection tank	Water level sensor signal error, no water level high and low readings
E 9	Water level sensor error, drinking water tank	Water level sensor signal error, no water level high and low readings

! IMPORTANT !

- Error codes table is for reference and customer support purpose ONLY
- Any unauthorized attempt to disassemble, repair the machine would automatically void the warranty.
- Please contact customer service, support@aerstreamh2o.com for assistance.